

FOR LEASE

SUPER 8 BUSINESS CENTRE

26 Strathmoor Drive, Sherwood Park, AB



HIGHLIGHTS

- 602 sq ft ± & 1,843 sq ft ± spaces available
- Common washrooms for smaller offices
- Excellent access to Broadmoor Blvd, Yellowhead Hwy and Anthony Henday

SCOTT ENDRES

Partner, Broker
C 780.720.6541
scott@royalparkrealty.com

JOEL WOLSKI

Director, Associate
C 780.904.5630
joel@royalparkrealty.com

RAYA WOLSKI

Licensed Assistant
T 780.423.7599
raya@royalparkrealty.com



ROYAL PARK
REALTY™

T 780.448.0800 F 780.426.3007
#201, 9038 51 Avenue NW Edmonton, AB T6E 5X4

royalparkrealty.com

For Lease | Units 4 & 5, 26 Strathmoor Drive, Sherwood Park, AB

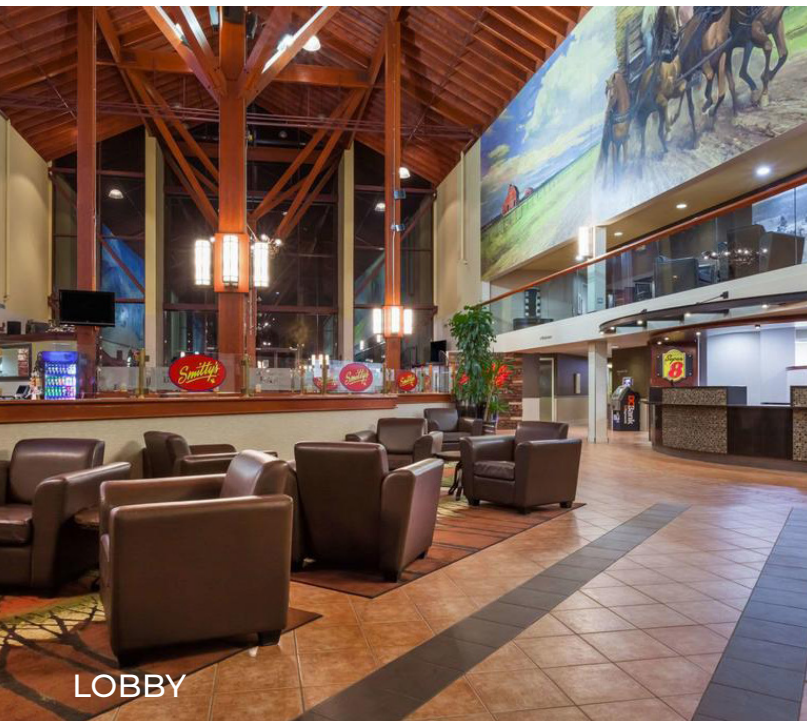

LOBBY

Property Details & Financials

MUNICIPAL ADDRESS	26 Strathmoor Drive, Sherwood Park, AB
LEGAL DESCRIPTION	Plan: 0123559; Block: 1; Lot: 18
ZONING	C3 (Highway Commercial)
TYPE OF SPACE	Retail/Office
UNIT 4	602 sq ft ±
UNIT 5	1,843 sq ft ±
PARKING	Ample
LEASE RATE	\$1,500.00 gross/month
POSSESSION	Immediate



ROYAL PARK
REALTY™

T 780.448.0800 F 780.426.3007
#201, 9038 51 Avenue NW Edmonton, AB T6E 5X4

royalparkrealty.com

For Lease | Units 4 & 5, 26 Strathmoor Drive, Sherwood Park, AB



**ROYAL PARK
REALTY™**

T 780.448.0800 F 780.426.3007
#201, 9038 51 Avenue NW Edmonton, AB T6E 5X4

royalparkrealty.com

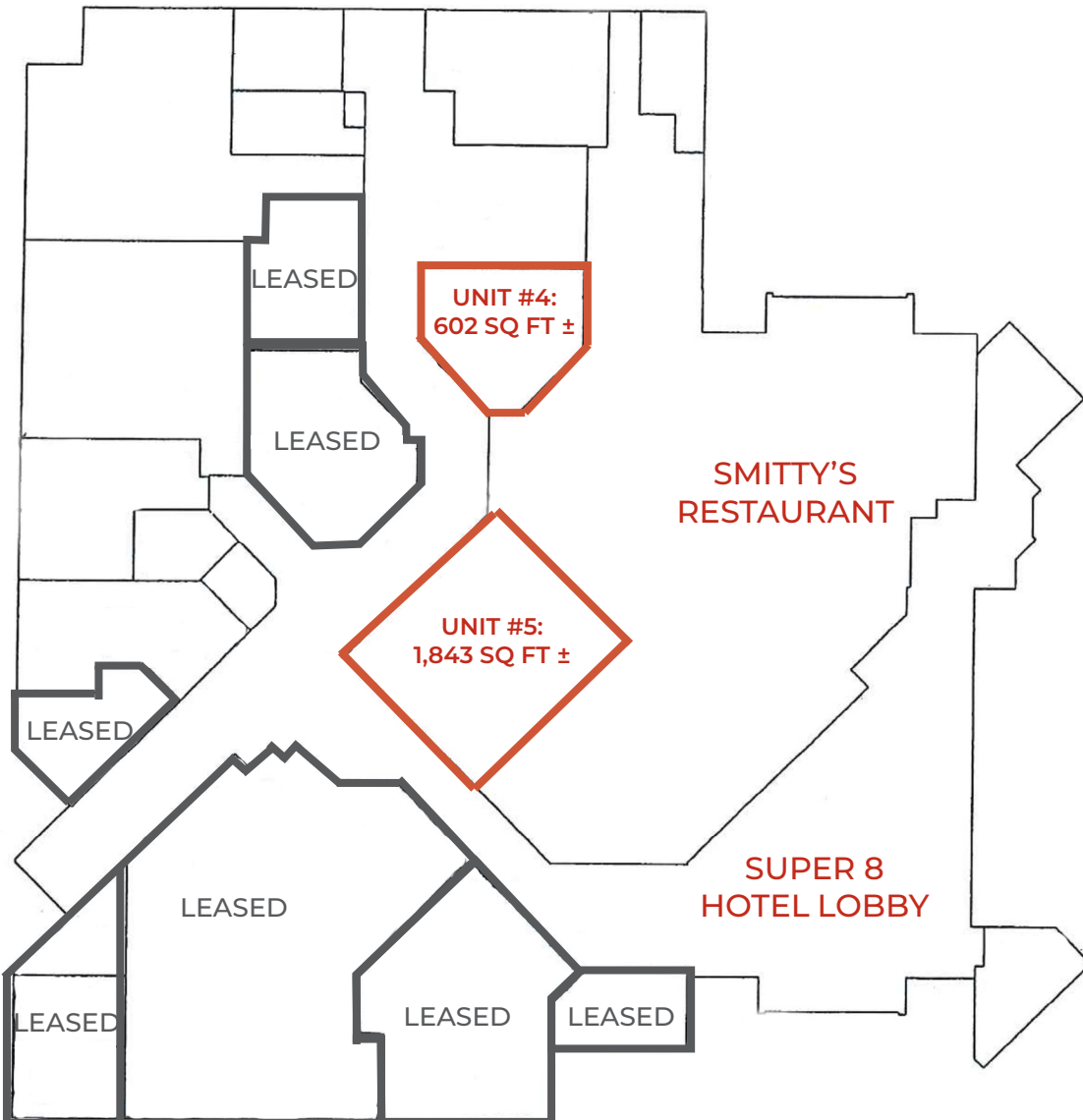

Quality Based on Results, Not Promises.



JOEL WOLSKI
Director, Associate
C 780.904.5630
joel@royalparkrealty.com



SCOTT ENDRES
Partner, Broker
C 780.720.6541
scott@royalparkrealty.com



RAYA WOLSKI
Licensed Assistant
T 780.423.7599
raya@royalparkrealty.com



**ROYAL PARK
REALTY™**

T 780.448.0800 F 780.426.3007
#201, 9038 51 Avenue NW Edmonton, AB T6E 5X4

royalparkrealty.com