

FOR LEASE

7,522 SQ FT OFFICE SPACE

2016 Sherwood Drive, Sherwood Park AB



HIGHLIGHTS

- 7,522 sqft +/- medical/office spaces available for lease
- New ownership and management
- Excellent on-site parking: 4.4 stalls per 1,000 sqft
- Property located across from Strathcona County Hall and Centre in The Park, located south of Sherwood Park Mall
- Fantastic mixed use property consisting of Park Hotel, Sawmill Prime Rib & Steak House, health and medical services, law offices, café and juice bar, childcare services and numerous professional businesses.

CONTACT

JEWELL HANSEN Associate
T 780.423.7587 C 780.919.7672
jewell@royalparkrealty.com



**ROYAL PARK
REALTY™**

T 780.448.0800 F 780.426.3007
6940 - 76 Avenue NW Edmonton, AB T6B 2R2

royalparkrealty.com

PROPERTY DETAILS

BUILDING NAME	Park Centre
MUNICIPAL ADDRESS	2016 Sherwood Drive Sherwood Park, AB
LEGAL DESCRIPTION	Plan: 3939TR; Block: 66; Lot: A
BUILDING TYPE	Hotel/Retail/Office/Healthcare
MAIN FLOOR	7,522 sqft (+/-) (usable)
SITE AREA	5.33 acres
POSSESSION	October 1st 2018
ZONING	C4 (Major Commercial)
PARKING	4.4 stalls/1000 sq ft Surface Stalls
HVAC	Yes
SPRINKLERED	Yes
LEASE TERM	3 - 10 years
TENANT IMPROVEMENT ALLOWANCE	Negotiable

FINANCIALS

LEASE DETAILS

BASIC LEASE RATE	\$12.00 - \$15.00 /sq ft
OPERATING COSTS	\$10.75/sq ft (estimated 2019) Includes CAM, Taxes, Insurance & Utilities

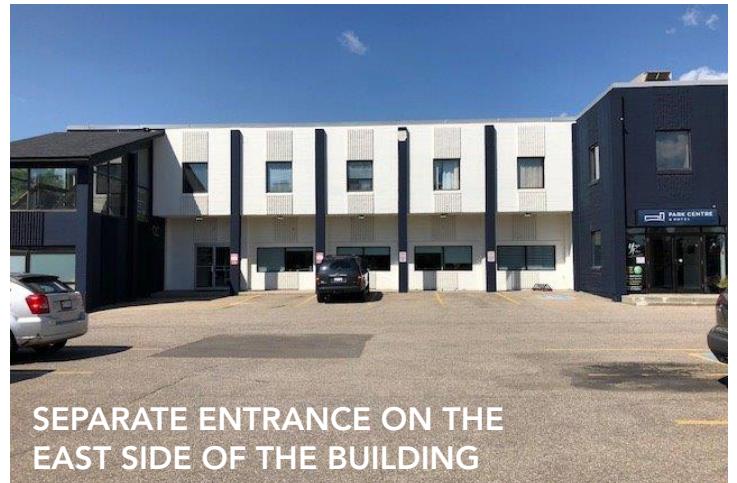

**ROYAL PARK
REALTY™**

T 780.448.0800 F 780.426.3007
6940 - 76 Avenue NW Edmonton, AB T6B 2R2

royalparkrealty.com

FLOOR PLAN - MAIN FLOOR (UNIT #123)

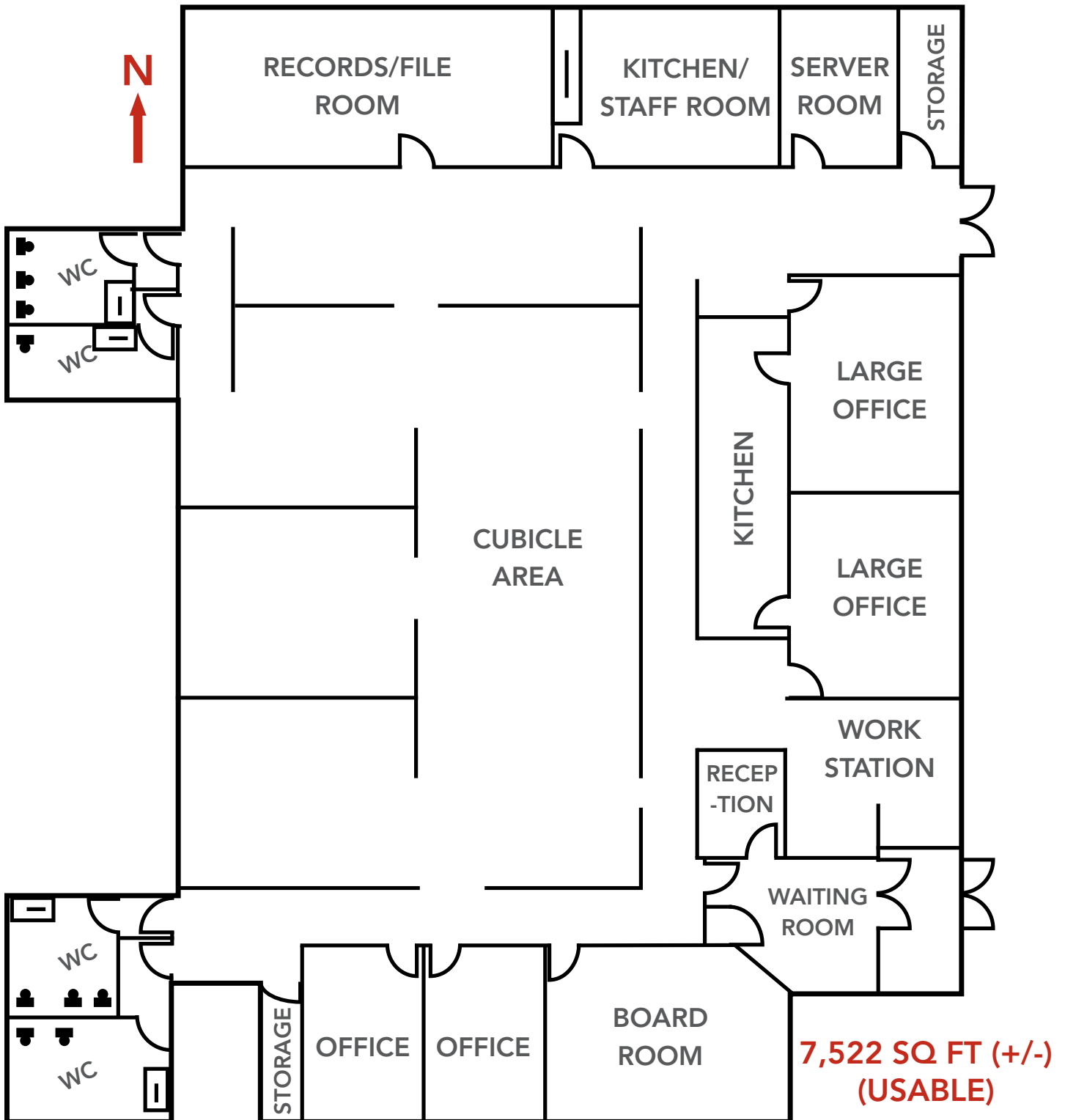

**7,522 SQ FT (+/-)
(USABLE)**



**ROYAL PARK
REALTY™**

T 780.448.0800 F 780.426.3007
6940 - 76 Avenue NW Edmonton, AB T6B 2R2

royalparkrealty.com

PHOTOS - MAIN FLOOR UNIT



PROPERTY LOCATION



ROYAL PARK
REALTY™

T 780.448.0800 F 780.426.3007
6940 - 76 Avenue NW Edmonton, AB T6B 2R2

royalparkrealty.com