

FOR LEASE

BROADMOOR HERITAGE PLAZA RETAIL/OFFICE/MEDICAL

800 Broadmoor Boulevard, Sherwood Park, AB

1 UNIT REMAINING

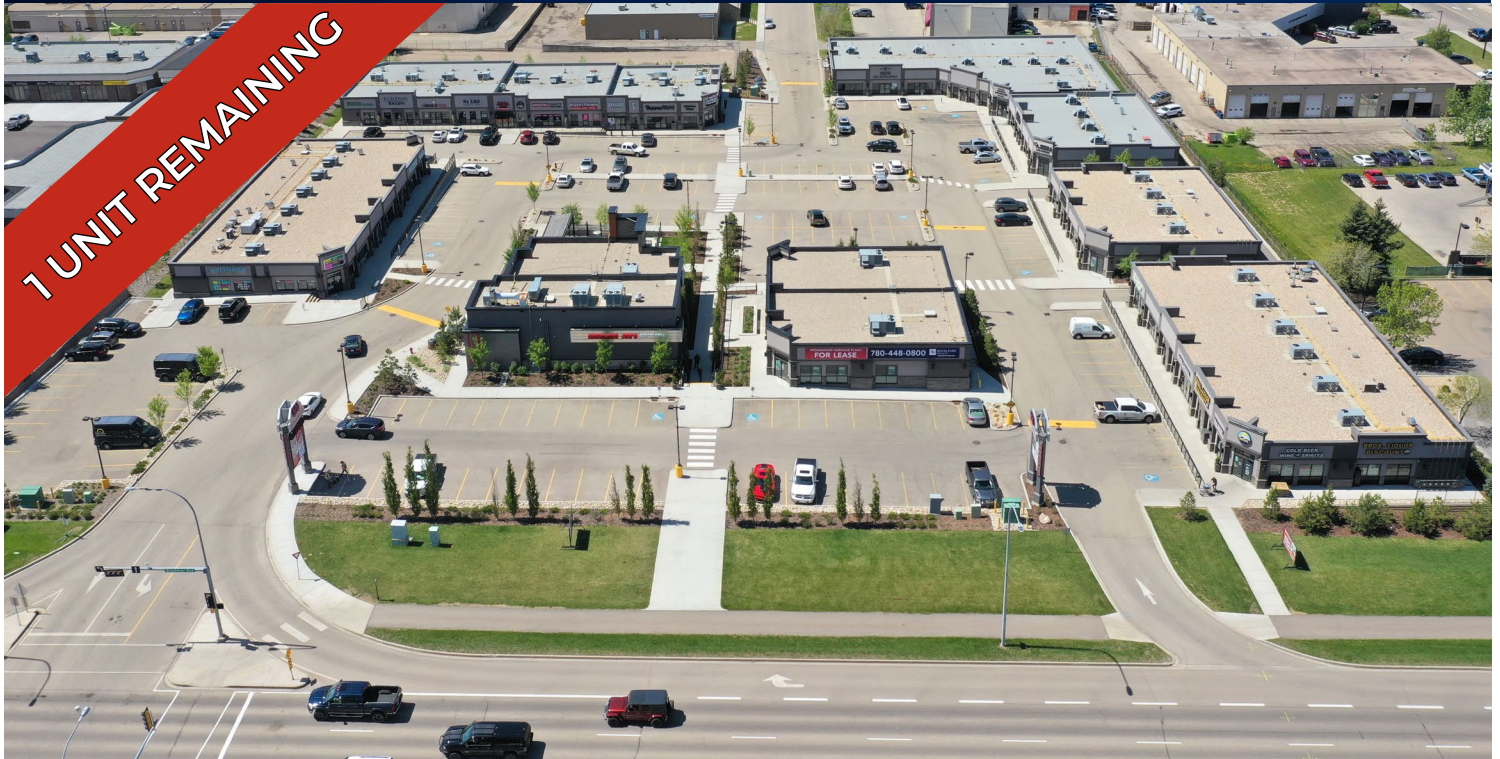

HIGHLIGHTS

- Prime retail plaza strategically located on Broadmoor Boulevard
- 1,137 sq ft ± space remaining
- Available for immediate possession
- Join Sherlock Holmes Pub, Japanese Village, Gem Gallerie, Mills Haven Dental, Bro's Liquor and more!
- Welcome new tenants: ZIGLE Korean Bulgogi Restaurant, Chop Shop Physiques, Maraki Shoes and more!

CONTACTS

JOEL WOLSKI

Director, Associate

T 780.423.7599

C 780.904.5630

joel@royalparkrealty.com

SCOTT ENDRES

Partner, Broker

T 780.423.7588

C 780.720.6541

scott@royalparkrealty.com

JOANNA LEWIS

Associate

T 780.423.7580

C 780.999.9642

joanna@royalparkrealty.com



ROYAL PARK
REALTY™

780.448.0800 780.426.3007
#201, 9038 51 Avenue NW Edmonton, AB T6E 5X4

royalparkrealty.com

PROPERTY DETAILS

MUNICIPAL ADDRESS	800 Broadmoor Blvd, Sherwood Park, AB
LEGAL DESCRIPTION	Condo Plan: 1620658; Units: 1-8
ZONING	C5 (Service Commercial)
TYPE OF SPACE	Retail/Office/Medical
SIZE	1,137 sq ft ±
HVAC	Yes
PARKING	Ample surface parking 3.2/1,000 sq ft 214 stalls total
POSSESSION	Immediate

FINANCIALS

LEASE RATE	Starting at \$25.00/sq ft
OPERATING COSTS	\$11.04/sq ft (property taxes, building insurance, property maintenance, management fee)
TERM	5 - 10 years
TI ALLOWANCE	Negotiable

ADDITIONAL INFORMATION

- Direct frontage to Broadmoor Boulevard
- Sherwood Park provides exceptional services and transportation routes giving access across the greater Edmonton area



ROYAL PARK
REALTY™

780.448.0800 780.426.3007
#201, 9038 51 Avenue NW Edmonton, AB T6E 5X4

royalparkrealty.com

PHOTOS



ROYAL PARK
REALTY™

780.448.0800 780.426.3007
#201, 9038 51 Avenue NW Edmonton, AB T6E 5X4

royalparkrealty.com

The information contained herein is believed to be correct, however does not form part of any future contract. The offering may be withdrawn at any time without notice or cause.

SITE PLAN

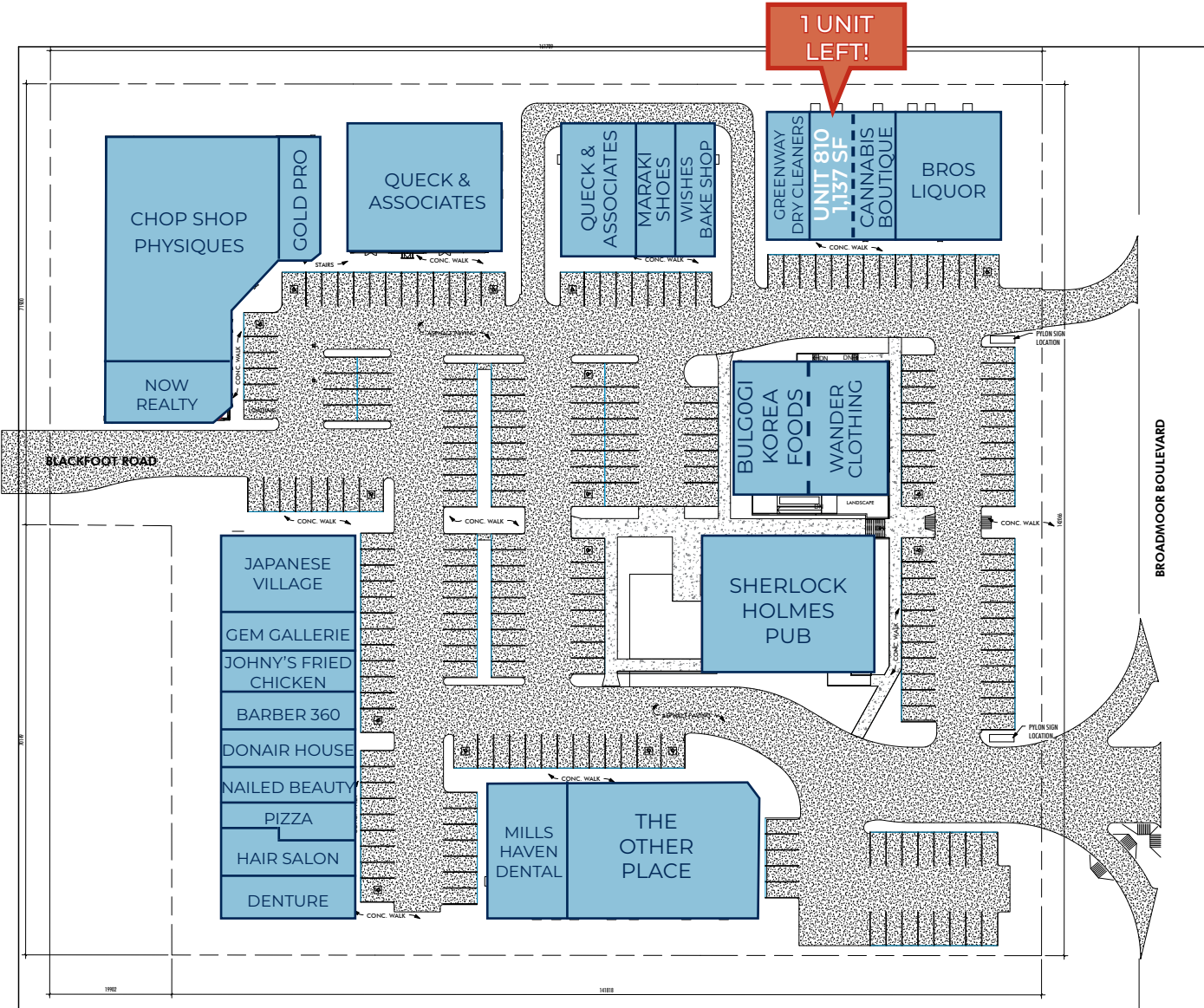

ROYAL PARK
REALTY™

780.448.0800 780.426.3007
#201, 9038 51 Avenue NW Edmonton, AB T6E 5X4

royalparkrealty.com

PROPERTY LOCATION

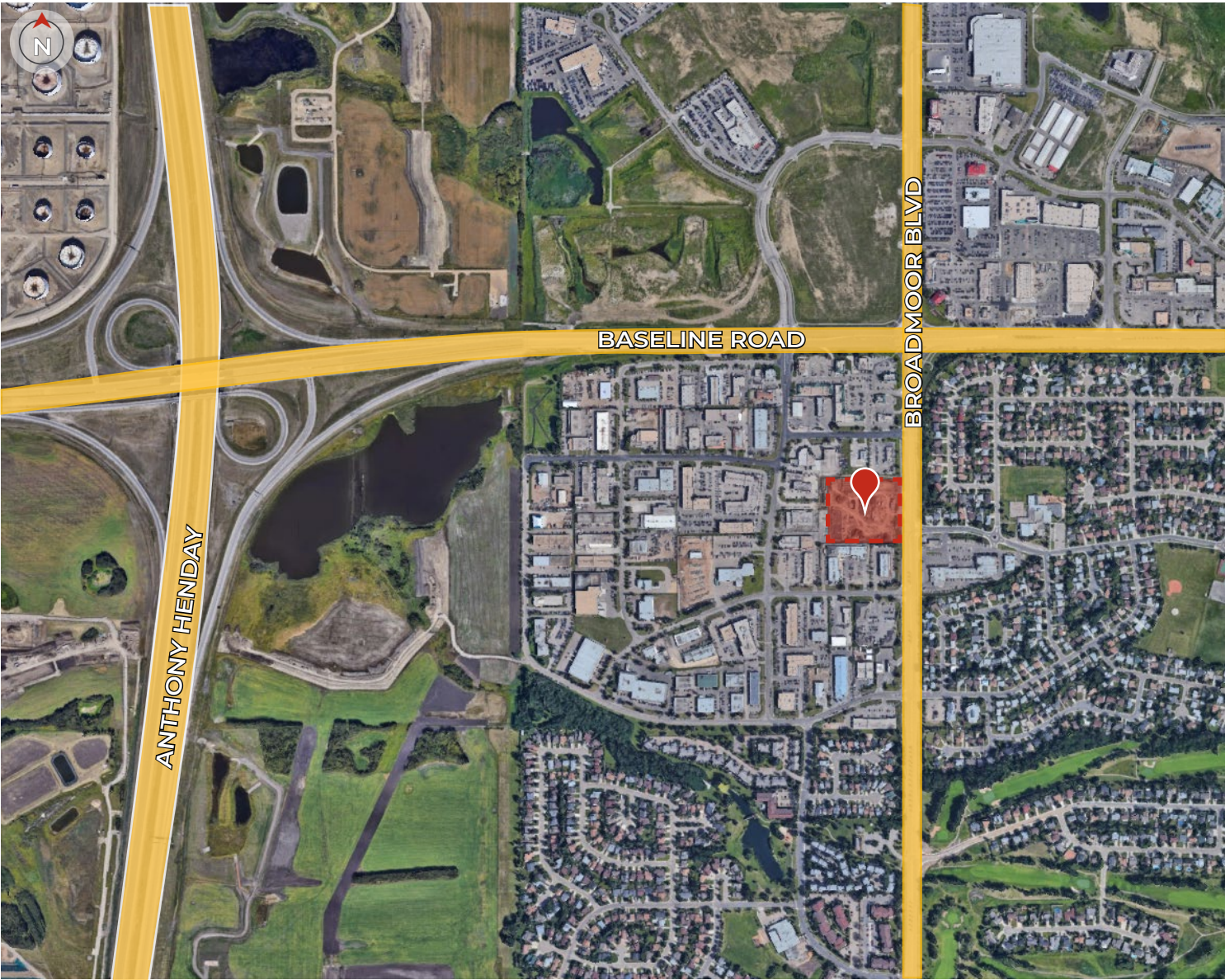

DRIVE TIME MINUTES TO HENDAY & BASELINE ROAD	PUBLIC TRANSIT BUS	HIGHWAY ACCESS ANTHONY HENDAY & YELLOWHEAD HWY	CONNECTIVITY FIBRE OPTIC	PARKING SURFACE & STREET PARKING AVAILABLE	ZONING SERVICE COMMERCIAL (C5)

ABOUT ROYAL PARK REALTY

- › We've been in business since 1975
- › We service the greater Edmonton area
- › Two offices - Edmonton and Nisku
- › Commercial real estate only. We have tremendous experience with industrial, land, office and retail real estate
- › We're in business for the long term - our brand and reputation are paramount to us & we serve our clients accordingly



**ROYAL PARK
REALTY™**

780.448.0800 780.426.3007
#201, 9038 51 Avenue NW Edmonton, AB T6E 5X4

royalparkrealty.com

The information contained herein is believed to be correct, however does not form part of any future contract. The offering may be withdrawn at any time without notice or cause.



ROYAL PARK
REALTY™

780.448.0800 780.426.3007
#201, 9038 51 Avenue NW Edmonton, AB T6E 5X4

royalparkrealty.com

The information contained herein is believed to be correct, however does not form part of any future contract. The offering may be withdrawn at any time without notice or cause.