

FOR LEASE

BROADMOOR HERITAGE PLAZA RETAIL/OFFICE/MEDICAL

#590, 800 Broadmoor Boulevard, Sherwood Park, AB



HIGHLIGHTS

- 1,312 sq ft ± space currently built out as a spa/massage studio
- Prime retail plaza strategically located on Broadmoor Boulevard
- Available for immediate possession
- Join Sherlock Holmes Pub, Japanese Village, Gem Gallerie, Mills Haven Dental, Bro's Liquor and more!

CONTACTS

JOEL WOLSKI

Director, Associate

T 780.423.7599

C 780.904.5630

joel@royalparkrealty.com

SCOTT ENDRES

Partner, Broker

T 780.423.7588

C 780.720.6541

scott@royalparkrealty.com



ROYAL PARK
REALTY™

780.448.0800 780.426.3007
#201, 9038 51 Avenue NW Edmonton, AB T6E 5X4

royalparkrealty.com

PROPERTY DETAILS

MUNICIPAL ADDRESS	Unit 590, 800 Broadmoor Blvd, Sherwood Park, AB
LEGAL DESCRIPTION	Condo Plan: 1620658; Unit: 590
ZONING	C5 (Service Commercial)
TYPE OF SPACE	Retail/Office
SIZE	1,312 sq ft ±
HVAC	Yes
PARKING	Ample surface parking 3.2/1,000 sq ft 214 stalls total
POSSESSION	Immediate

FINANCIALS

LEASE RATE	\$20.00/sq ft
OPERATING COSTS	\$10.25/sq ft (property taxes, building insurance, property maintenance, management fee)
TERM	5 - 10 years
TI ALLOWANCE	Negotiable

ADDITIONAL INFORMATION

- Direct frontage to Broadmoor Boulevard
- Currently built out as a spa/massage
- Sherwood Park provides exceptional services and transportation routes giving access across the greater Edmonton area



ROYAL PARK
REALTY™

780.448.0800 780.426.3007
#201, 9038 51 Avenue NW Edmonton, AB T6E 5X4

royalparkrealty.com

PHOTOS



ROYAL PARK
REALTY™

780.448.0800 780.426.3007
#201, 9038 51 Avenue NW Edmonton, AB T6E 5X4

royalparkrealty.com

SITE PLAN

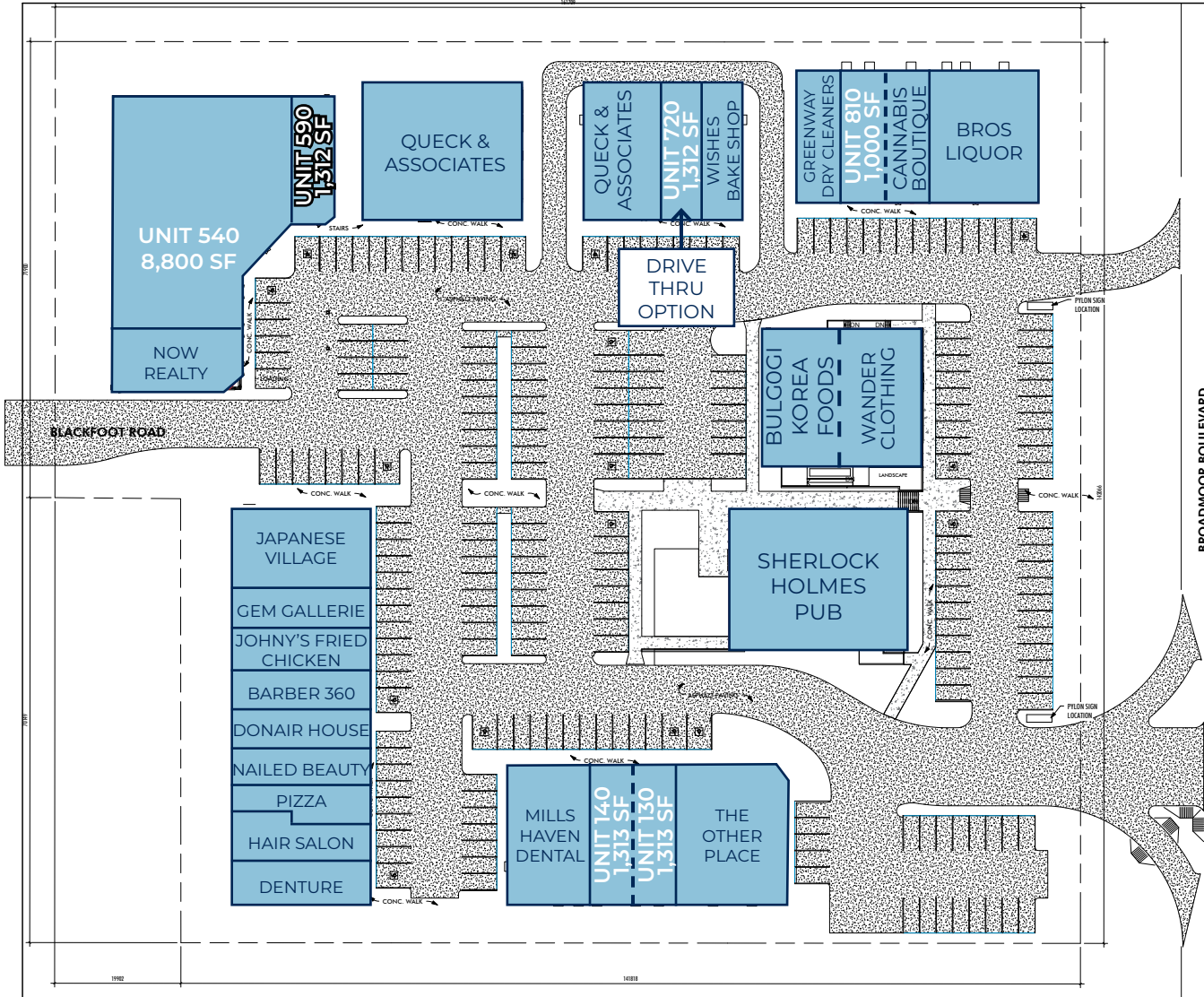

ROYAL PARK
REALTY™

780.448.0800 780.426.3007
#201, 9038 51 Avenue NW Edmonton, AB T6E 5X4

royalparkrealty.com

PROPERTY LOCATION

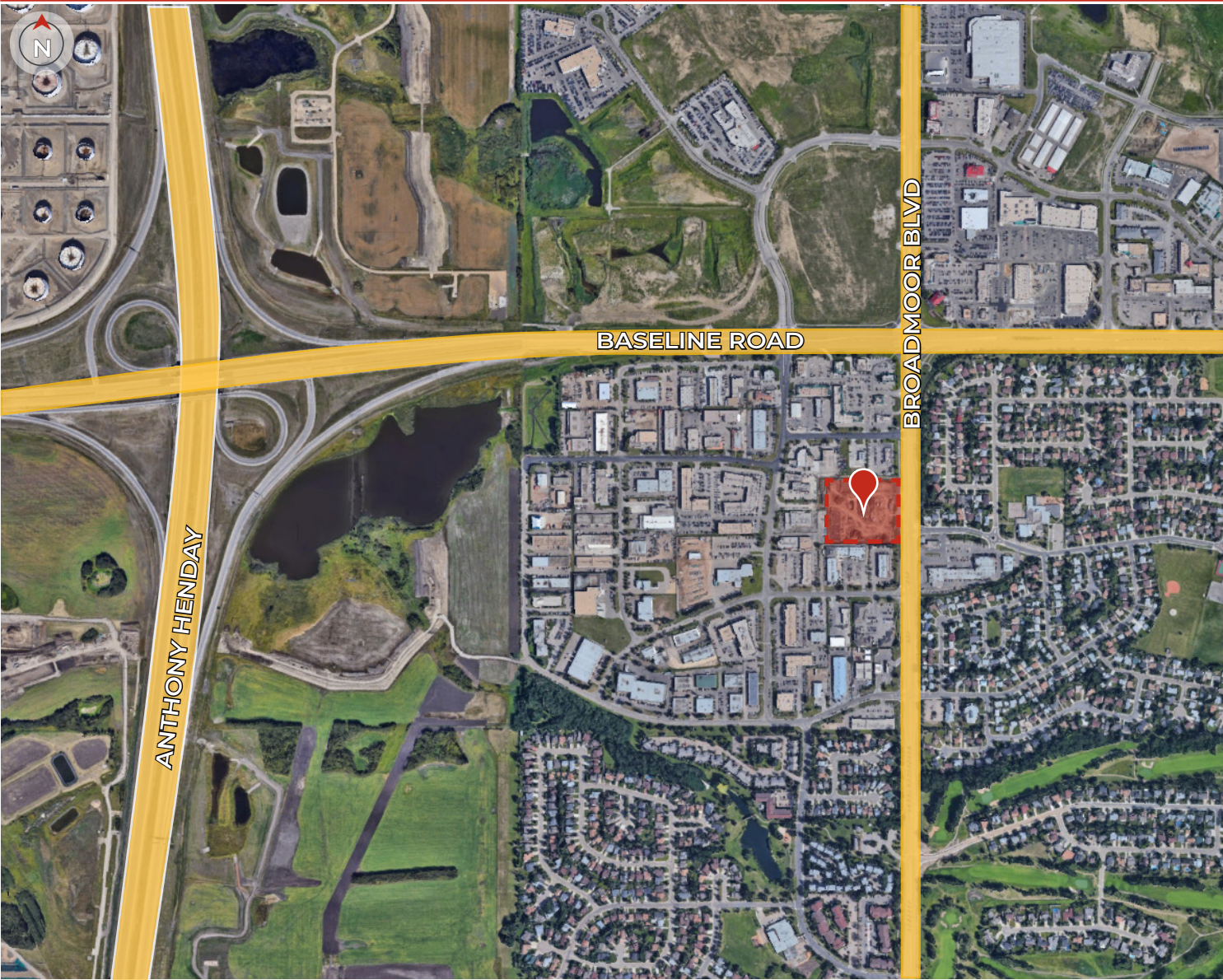

DRIVE TIME MINUTES TO HENDAY & BASELINE ROAD	PUBLIC TRANSIT BUS	HIGHWAY ACCESS ANTHONY HENDAY & YELLOWHEAD HWY	CONNECTIVITY FIBRE OPTIC	PARKING SURFACE & STREET PARKING AVAILABLE	ZONING SERVICE COMMERCIAL (C5)

ABOUT ROYAL PARK REALTY

- › We've been in business since 1975
- › We service the greater Edmonton area
- › Two offices - Edmonton and Nisku
- › Commercial real estate only. We have tremendous experience with industrial, land, office and retail real estate
- › We're in business for the long term - our brand and reputation are paramount to us & we serve our clients accordingly

	ROYAL PARK REALTY™	780.448.0800 780.426.3007 #201, 9038 51 Avenue NW Edmonton, AB T6E 5X4 royalparkrealty.com
--	-------------------------------	---



ROYAL PARK
REALTY™

780.448.0800 780.426.3007
#201, 9038 51 Avenue NW Edmonton, AB T6E 5X4

royalparkrealty.com